

## FACT SHEET 2017

Madikwe & The Reserve Pg1 | The Lodges Pg4 | Architectural Layouts Pg5 | Transfers Pg8 | Directions Pg9

Lelapa Lodge | Drienie Viljoen | Tel: +27 (0) 18 350 9902 | Email: drienie@madikwesafarilodge.co.za  
Kopano & Dithaba Lodge | Johan de Villiers | Tel: +27 (0) 18 350 9902 | Email: johan@madikwesafarilodge.co.za  
Head Office / Reservations | Tel: +27 (0) 11 880 9992 | Email: res@madikwesafarilodge.co.za | Website: www.madikwesafarilodge.co.za  
[www.more.co.za](http://www.more.co.za)

### Unique Selling Points

Situated in one of South Africa's largest malaria-free sanctuaries • Rich biodiversity of mammals, such as Africa's Big Five, cheetah, wild dog, brown and spotted hyena, oryx, eland, springbok and ostrich • Excellent birdwatching with over 350 bird species • Diverse geology and broad mix of habitats • Exceptional field rangers. Intimate accommodation with sweeping views over the game-filled plains with the Dwarsberg range forming a purple-hued backdrop • A unique area imbued in history - Mzilikazi, Dr David Livingstone, Sir William Cornwallis-Harris and Herman Charles Bosman • Effortless road and air access • Part of the family-owned and operated collection of MORE properties.

### Madikwe - Elemental Safari Living

#### Lelapa Lodge

Lelapa literally means 'family' - there is no restriction in terms of age or generation. Each of the 12 Suites (approximately 100 m<sup>2</sup>/1080 ft<sup>2</sup>) has indoor and outdoor showers; private plunge pool; wood-burning fireplace; a double bed (convertible to twins); air-conditioning; ceiling fan; bathroom en-suite; safe; mini bar; direct-dial telephone; hairdryer and a range of deluxe amenities. Four rooms are Family Suites, and have a second bedroom with children's bunk beds and sleeper couch.

#### Kopano Lodge

Kopano directly translated means 'small gathering'. Each of the 4 Suites (approximately 100 m<sup>2</sup>/1080 ft<sup>2</sup>) has indoor and outdoor showers; wood-burning fireplace a double bed (convertible to twins); air-conditioning; ceiling fan; bathroom en-suite; safe; mini bar; direct-dial telephone; hairdryer and a range of deluxe amenities. No children under 16 years, unless the lodge is booked on an exclusive basis.

#### Dithaba Lodge

This Lodge is well suited to a group of friends or family members. Each of the 4 Suites (approximately 110 m<sup>2</sup>/1180 ft<sup>2</sup>) has indoor and outdoor showers; private plunge pool; wood-burning fireplace; a double bed (convertible to twins); air-conditioning; fireplace; ceiling fan; bathroom en-suite; safe; mini bar; direct-dial telephone; hairdryer and a range of deluxe amenities.

### Best Time to Travel

An all-year-round safari destination where the variation in experience is temperature-related rather than safari-related, as there are no migratory mammal species. The best bird-watching period is from October to April.

### Location

In the central eastern region of the richly diverse and malaria-free 76 000 hectare (187 800 acre) Madikwe Game Reserve, North West Province, South Africa, bordering Botswana. The area in which Madikwe Safari Lodge is located is well known for providing the best game viewing within the Reserve, as well as having the lowest concentration of safari vehicles, which make for a superior game viewing experience.

### Activities

Morning and evening game drives in open safari vehicles • Bush walks • Bird watching • Astronomy. Local community village tour • Bush breakfasts and dinners • Boma dinners • Spa • Children's activities • Eco house.

## The Rhino Conservation Experience

Madikwe Game Reserve is committed to wildlife conservation, particularly when it comes to its critically endangered rhino species. To this end, the reserve has established The Honorary Officers Counter Poaching Unit (HOCPU), headed up by Phillip Hattingh. Madikwe Safari Lodge's guests have the unique opportunity to contribute to, and experience, critical conservation in action through **The Rhino Conservation Experience**.

After an early morning wakeup call, followed by coffee/ tea and a light refreshment, guests are transferred to Madikwe's Airstrip to meet up with Phillip, park representatives and a veterinary specialist. Following a brief introduction on rhino conservation and an overview of the plan of action, the vet will depart in a helicopter to find and dart a rhino in the vicinity. Safari vehicles are in continuous radio contact, and remain on standby until the location of the rhino is called in. Guests are then transferred to the scene where the rhino is sedated, to participate in the process of gathering DNA samples and notching. The rhino is soon on its feet (sedated for no more than 10-15 minutes to minimise stress), now part of the reference book of identifiable rhinos within Madikwe's population.

It is through this process that Field Guides are able to identify and record rhino sightings for the purpose of monitoring the health of the population. In addition, the DNA samples are sent to Onderstepoort so that each animal's unique ID can be added to the national database. The recording of DNA is vital in order to gain convictions against poachers.

**Cost per Rhino Notching Experience:** ZAR 44,000 (for a maximum of 16 participants in 2 safari vehicles).

**Includes:** Cost of helicopter, veterinary specialist and access to dedicated park officials; the exclusive encounter with a sedated rhino; tea/ coffee and refreshments during orientation.

## Families on Safari

Children of all ages are welcome at Madikwe Safari Lodge's Lelapa Lodge • There are many activities available for children including: family safari drives; bush orientation; bug CSI; dung tracking; track pack with Plaster of Paris; baking in the kitchen; making pizzas in the boma; star gazing; games and much more • Children under the age of 3 years are not permitted on any of the daily safari drives • Children between the ages of zero and five years stay free of charge and children aged six to fifteen pay 50% of the per person adult rate • Children younger than 6 years old are not permitted on the scheduled daily safari drives that take place early mornings & late afternoons. Children aged between 3 and 5 years old may participate on a dedicated family safari game drive between 10h00am & 12h00pm daily in summer, and between 11h00am & 13h00pm in winter. Parents are welcome to join this game drive too, subject to the availability of seats on the vehicle.

### Rates

**Rates include:** Luxury accommodation; all meals; teas/coffees; all local beverages (including soft drinks, local brand beers, spirits and house wines); mini bar; wifi (guest areas); two game drives daily; game drive refreshments and snacks; transfers to and from Madikwe eastern Airstrip; and specified safari activities.

**Rates exclude:** Laundry; premium brand or imported beers; spirits; cellar wines and champagnes; cigars and cigarettes; transfers not specified; gratuities; communication costs; curio shop purchases; spa treatments; Madikwe Game Reserve landing fees; Madikwe Game Reserve entrance/conservation fees; and activities not included.

## Malaria

Madikwe is situated in a region of South Africa which the malaria carrying mosquito (Anopheles) does not inhabit, and the reserve and region is therefore classed as a malaria-free region.

## Weather

The climate is typified by hot wet summers (September to April) and cool dry winters (May to August). Temperatures average around 25°C (77°F) but can get very hot during heat waves in mid- summer and extremely cold at night in mid-winter. The region is classed as a semi-arid region. Rainfall amounts to about 500 mm (19.5 inches) per year, with most of this falling in short, sharp thunderstorms in the late afternoons or at night, between November and March.

### Average temperatures:

Summer: 25°C (77°F) to 40°C (104°F)

Winter: 3°C (38°F) to 23°C (73°F).

## Access

- Federal Air operates a daily flight from O.R. Tambo International Airport (JNB) to Madikwe Airfield. The airfield is 10 minutes drive from the Lodge. Refer to page 8 for detailed information.
- Gaborone, Botswana is 2 hours from Madikwe Safari Lodge. If you are either coming from or going on safari in Botswana, transfers can be arranged.
- Unique Air operates air transfers between Madikwe Safari Lodge and Marataba Safari Lodge. Refer to page 8 for detailed information.
- The driving time from Johannesburg is approximately 4 to 4.5 hours, and there are two different routes to consider:

- **O.R. Tambo International Airport (JNB) to Madikwe Safari Lodge via Abjaterskop Gate.**

*Note:* this route is recommended if you prefer to travel a shorter distance on a gravel road, bearing in mind neither route requires a 4x4 vehicle.

- **O.R. Tambo International Airport (JNB) to Madikwe Safari Lodge via Molatedi Gate (Sun City).**

*Note:* this route is recommended if you do not mind travelling 50 kilometres/30 miles on a gravel road, or if you are coming from or going to Sun City. This is a shorter route in distance, does not require a 4x4 vehicle and is more scenic.

*Refer Land & Air Transfers section on page 8 for detailed information.*

*MORE reservations can send you detailed information on both flight and self-drive access.*

## Distance (Madikwe to)

Location	Travel Time	Kilometres	Miles
Oliver Tambo International Airport, Johannesburg	4h 45min	359 km	224 miles
Lanseria Airport, Johannesburg	4h 15min	315 km	196 miles
Sir Seretse Khama International Airport, Gaborone	1 h 45min	87 km	55 miles
Sun City	2 hours	138 km	86 miles

## Programme

Summer (Sept to April)	Programme	Winter (May to August)
05h00	Wake up call	06h30
05h30	Game drive departs after tea / coffee	07h00
09h00	Game drive returns, then breakfast / brunch is served	09h30
	Bush walk, or personal leisure time	
16h00	High tea	15h00
16h30	Game drive departs	15h30
19h30	Game drive returns, and dinner is served	18h30

## Reference Table

Reference	Lelapa Lodge	Kopano Lodge	Dithaba Lodge
Suites	12	4	4
Size of suites	100 m <sup>2</sup> /1080 ft <sup>2</sup>	100 m <sup>2</sup> /1080 ft <sup>2</sup>	110 m <sup>2</sup> /1180 ft <sup>2</sup>
Guests	24	8	8
Children	Yes (all ages)	>16	>16 (unless booked exclusively - all ages)
Children's rate	< 5 free; 6 - 15 50%	Not applicable	< 5 free; 6 - 15 50% (If booked exclusively)
Children on safari	Yes (< 5 / Family Safari; 6 > Normal Safari)	Not applicable	Yes (If booked exclusively)
Children activities	Yes	Not applicable	Yes (If booked exclusively)
Babysitting	Yes (Extra cost)	Not applicable	Yes (Extra cost)
Triple rooms (sleeper couch)	5	0	2
Single traveller supplement	50%	50%	50%
Double bed convertible to twin	Yes	Yes	Yes
Treehouse/s	Coming soon		
Central public pool	Yes	No	No
Private plunge pool	Yes	Yes	Yes
Air-conditioning	Yes	Yes	Yes
Fireplace	Yes	Yes	Yes
Room fans	Yes	Yes	Yes
Mosquito nets	Not required	Not required	Not required
Outdoor shower	Yes	Yes	Yes
Indoor showers	Yes	Yes	Yes
Separate W.C.	Yes	Yes	Yes
Free Wi-Fi	Yes	Yes	Yes
Satellite television	Yes (Public area only)	No	Yes (Public area only)
In room telephone	Yes (Dial direct)	Yes (Dial direct)	Yes (Dial direct)
Mobile coverage	Average, 60% (MTN/Vodacom)	Average, 60% (MTN/Vodacom)	Average, 60% (MTN/Vodacom)
In room safe	Yes	Yes	Yes
Personal bars	Yes	Yes	Yes
Telephone	Yes	Yes	Yes
Hairdryers	Yes	Yes	Yes
Laundry	Yes (Extra cost)	Yes (Extra cost)	Yes (Extra cost)
Conference facilities	Yes (But no dedicated room)	No	Yes (But no dedicated room)
Suitable for disabled guests	Yes (With assistance)	Yes (With assistance)	No
Distance between rooms	10-15 m (33-49 ft)	10-15 m (33-49 ft)	10-15 m (33-49 ft)
Flights	Daily (55 min from Oliver Tambo International Airport, Johannesburg)		
Airfield	Yes (10 minutes) 24° 44' 0" S, 26° 24' 0" E	Yes (15 minutes) 24° 44' 0" S, 26° 24' 0" E	Yes (15 minutes) 24° 44' 0" S, 26° 24' 0" E
Landing fees	Yes (ZAR 240.00 per adult and ZAR 150.00 per child ) *subject to change without prior notice, and applies to one way and return flights		
Park fees	Yes (ZAR 210.00 per adult and ZAR 105.00 per child) *subject to change without prior notice)		
Guest Conservation Contribution (GCC)	ZAR 150.00 per person per day		
Helipad	Yes (24° 43' 11.8" S, 26° 23' 04.2" E)		
Guests per safari vehicle	8	8	8
Private 4x4 safari vehicle	Yes (Subject to availability)		
Private 4x4 safari vehicle rate	ZAR 7,550.00 per day		
Languages of field rangers	English, Afrikaans		
Gratuity recommendation	ZAR 500.00 per room per day (ZAR 200.00 guide, ZAR 200.00 general staff; ZAR 100.00 butler)		
Kosher food	Yes (With prior notice, extra cost)		
Power	220v AC	220v AC	220v AC
Credit cards	Visa and MC	Visa and MC	Visa and MC

**Lelapa Lodge Layout**

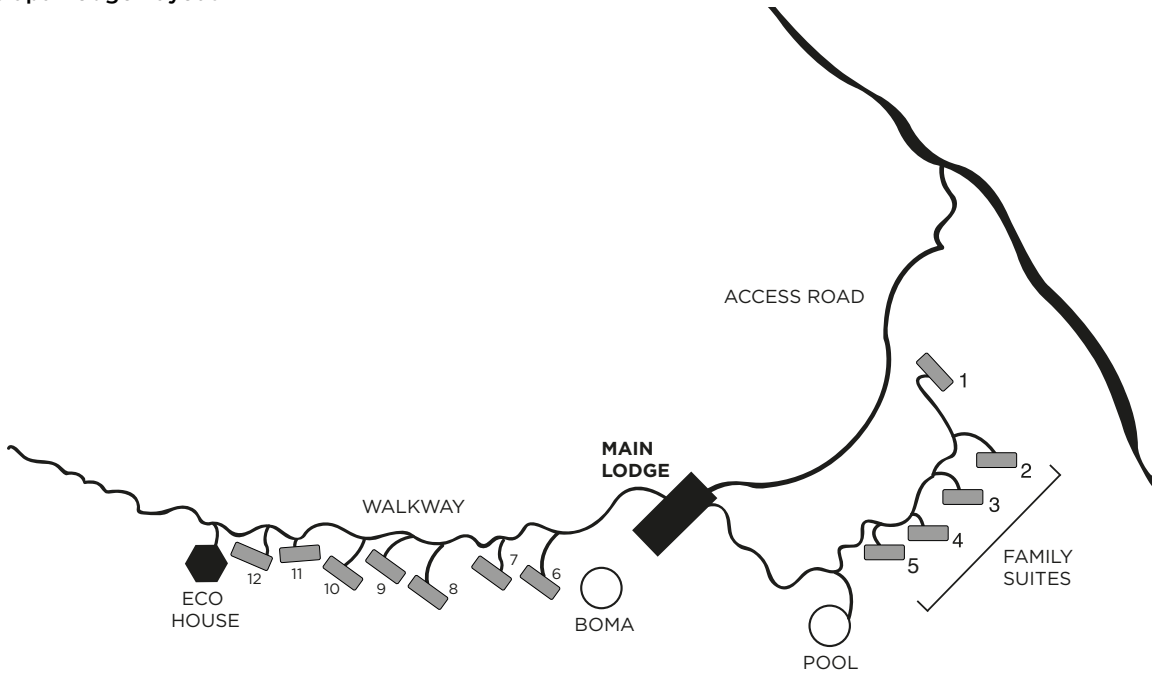

**Lelapa Suite Layout**

Interior - 50m<sup>2</sup> | 540 ft<sup>2</sup>  
 Exterior - 50m<sup>2</sup> | 540 ft<sup>2</sup>  
 Total - 100m<sup>2</sup> | 1080 ft<sup>2</sup>

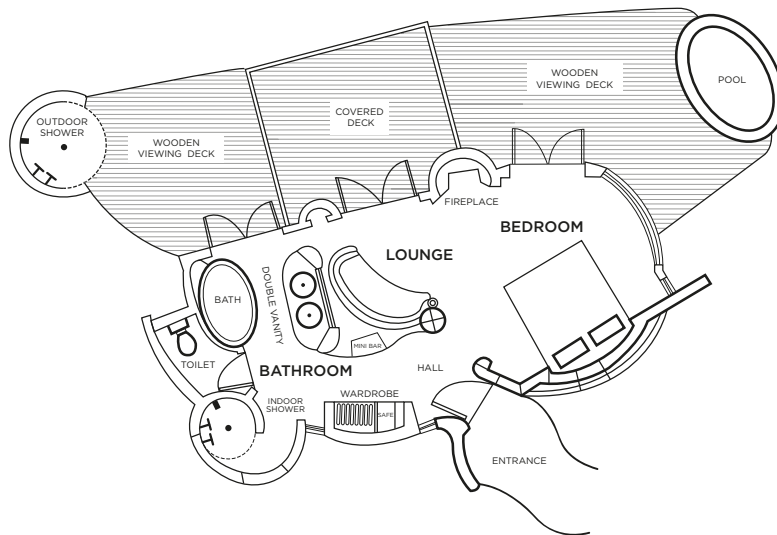

**Lelapa Family Suite Layout**

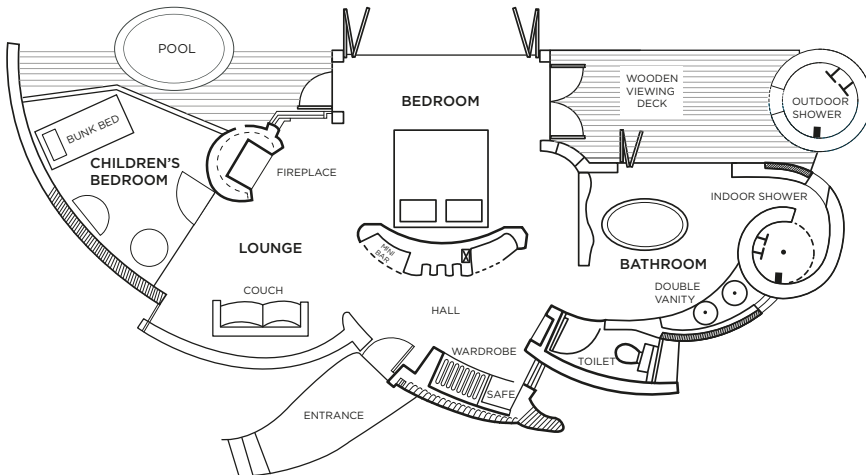

## Kopano Lodge Layout

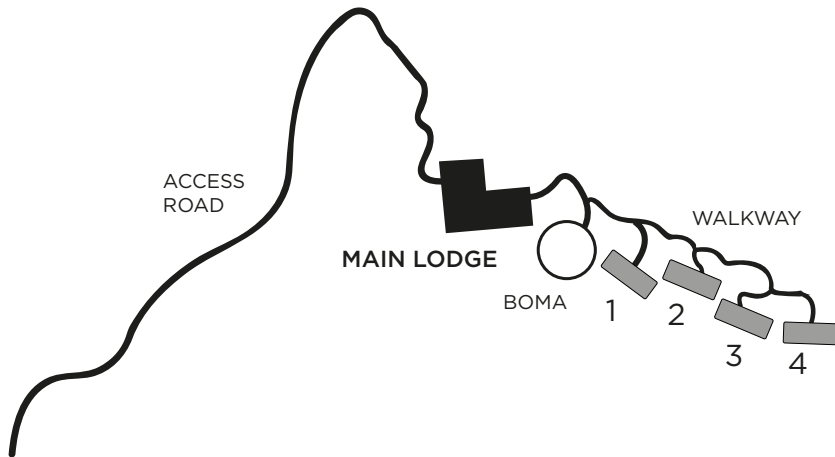

## Kopano Suite Layout

Interior - 50m<sup>2</sup> | 540 ft<sup>2</sup>  
Exterior - 50m<sup>2</sup> | 540 ft<sup>2</sup>  
Total - 100m<sup>2</sup> | 1080 ft<sup>2</sup>

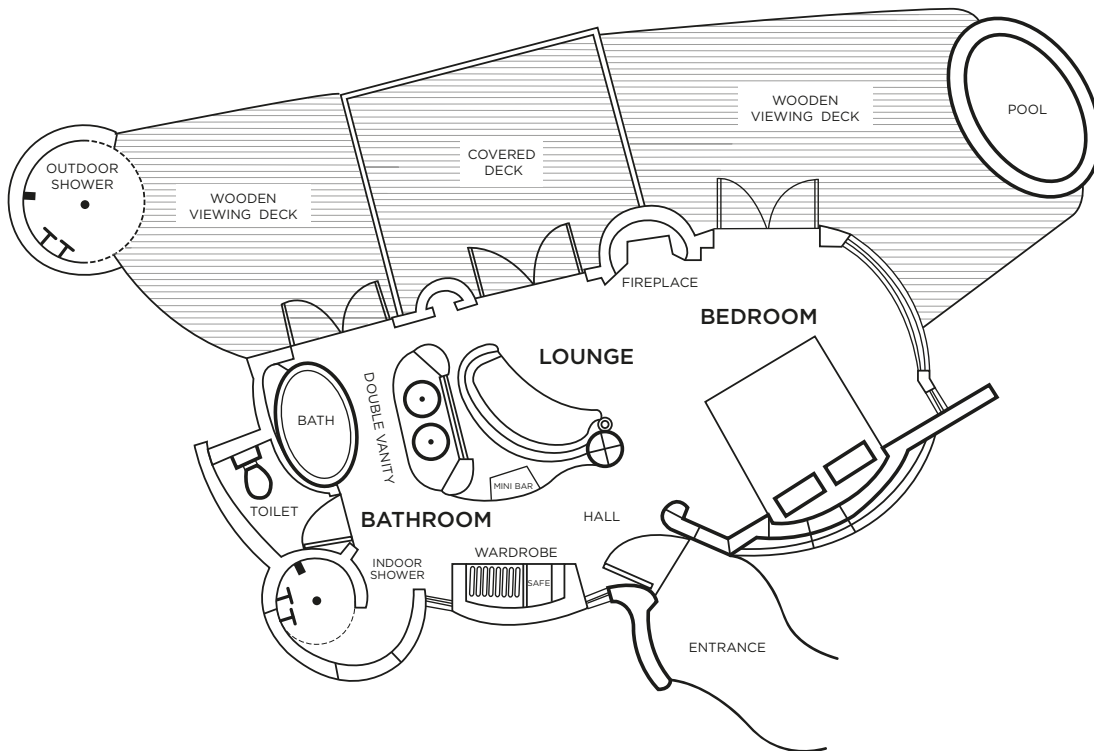

## Dithaba Lodge Layout

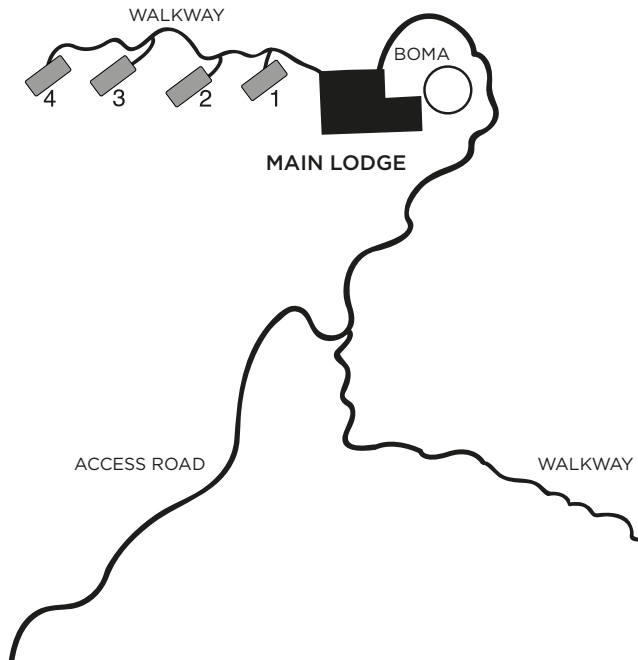

## Dithaba Suite Layout

Interior - 60m<sup>2</sup> | 640 ft<sup>2</sup>  
Exterior - 50m<sup>2</sup> | 540 ft<sup>2</sup>  
Total - 110m<sup>2</sup> | 1180 ft<sup>2</sup>

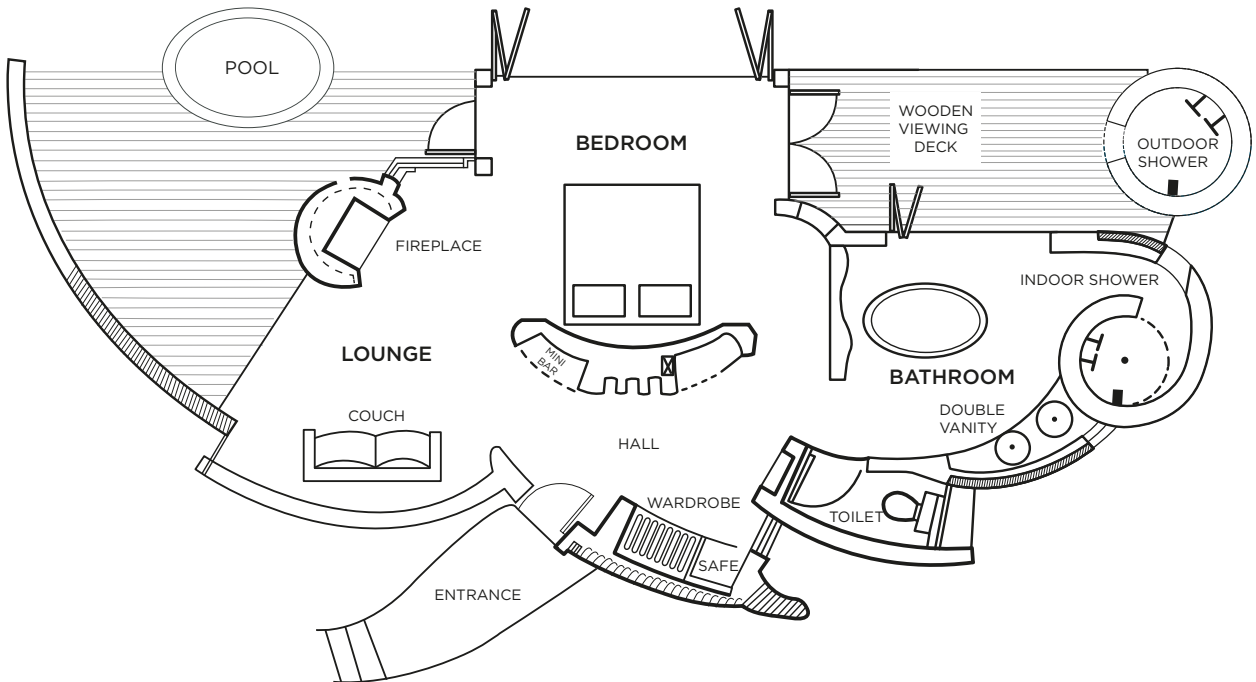

## Land & Air Transfers

### Air Transfers to Madikwe Safari Lodge

#### Charter Flights – Johannesburg to Madikwe Reserve:

There are daily scheduled charter flights, operated by Federal Air, available directly from Oliver Tambo International Airport (ORT) to Madikwe Reserve. The estimated time of this transfer is 1 hour. These charter flights can only be booked through MORE Reservations. Please see the timetables below for full details and fares:

#### Shuttle Timetable - Rates valid to 31 December 2017

Airport/ Airstrip		Times		Fare - per person one way
Departure	Arrival	Departure	Arrival	
JNB	Madikwe	13h00	14h00	ZAR 3,735.00
Madikwe	JNB	11h15	12h15	ZAR 3,735.00
Plus ZAR 200.00 fuel surcharge per flight per person				

- As the flight is USD based, the ZAR amount will be reviewed on a quarterly basis.

Baggage allowance for all mentioned flights: 20kg of soft luggage. Secure excess baggage storage facilities are available at the Federal Air lounge. Madikwe Reserve airport charges a ZAR 240.00 per adult and ZAR 150.00 per child landing fee for usage. This fee is fixed whether one way or return. We charge this directly to the guest's account which is settled upon check-out.

#### NOTE: Mara-dikwe Air Taxi

Effective 15 January 2018, MORE is launching a new daily Air Taxi between Grand Central, Marataba & Madikwe in partnership with Angel Gabriel. The service will operate out of Grand Central Airport, with a complimentary shuttle to/from OR Tambo.

#### Further information on the service is summarised below:

<b>Until 14 January 2018</b> <i>(cost pp one way; inclusive of VAT and all taxes; children pay full adult rate)</i>	Johannesburg - Marataba (current Marataba Air Taxi): R4,485 (until 31 December 2017)   R4,750 (1 - 14 January 2018)
<b>15 January - 31 December 2018</b> <i>(cost pp one way; inclusive of VAT and all taxes; children pay full adult rate)</i>	Johannesburg - Marataba: R4,750 Marataba - Madikwe: R2,375 Madikwe - Johannesburg: R3,925
<b>Routes &amp; times: counter-clockwise</b>	JHB - Marataba: Depart 12h00   Arrive: 13h00 Marataba - Madikwe: Depart 13h30   Arrive 14h00 Madikwe - JHB: Depart 14h30   Arrive 15h30
<b>Routes &amp; times: clockwise</b>	JHB - Madikwe: Depart 12h00   Arrive: 13h00 Madikwe - Marataba: Depart 13h30   Arrive 14h00 Marataba - JHB: Depart 14h30   Arrive 15h30
<b>Flight duration</b>	30 minutes to an hour (route dependent)
<b>Passengers</b>	2 passenger minimum. No maximum
<b>Baggage allowance</b>	15kg + 6kg carry on. Soft bags only
<b>Services</b>	Meet and greet service at OR Tambo (domestic and international); guests arrival details at OR Tambo to be supplied to Angel Gabriel; guests will be escorted to the Intercontinental where they can relax before being transported to Grand Central for their departing flight; luggage storage at Grand Central is on a return flight basis; if guests have a one-way flight, the Angel Gabriel staff will escort them to the storage facilities at OR Tambo International.



### Land Transfers from Johannesburg's O.R. Tambo International Airport to Madikwe Safari Lodge

Should you require a land transfer from Oliver Tambo International Airport (ORT) to Madikwe Safari Lodge, this can be booked and arranged through MORE Reservations. Guests will be met at the airport and transferred in an air- conditioned vehicle. Vehicles used are either a luxury Mercedes Benz C Class, or an SUV. Refer to page 3 for distances and travel times. Please see full details and rates included in our table below:

Route	Valid to 11 January 2018	Operated by
JNB to Madikwe	1 -3 guests - ZAR 5,519.00 per vehicle 4-7 guests - ZAR 7,206.00 per vehicle	MORE Private Travel
Sun City to Madikwe	1 -3 guests - ZAR 4,600.00 per vehicle 4-7 guests - ZAR 6,005.00 per vehicle	

For transfers departing Johannesburg after 12h00 or collecting from Madikwe before 10h00, please add driver's overnight accommodation of ZAR 750.00

### Land Transfers from Madikwe Airstrip to Madikwe Safari Lodge

Should you arrive at Madikwe Airstrip (Eastern) with a charter flight, Madikwe Safari Lodge will collect you in an open Land Rover and transfer you to the lodge. The distance is approximately 3 kilometres and is estimated to take 10-15 minutes.

This transfer service is complimentary.

### Land Transfers between Madikwe Safari Lodge and Marataba Safari Lodge

MORE Private Travel provides a transfer service between Madikwe Safari Lodge and Marataba Safari Lodge. This transfer is offered in a luxury air-conditioned vehicle and seats a maximum of 8 guests. The transfer takes approximately 2 hours. This service can only be booked directly with MORE reservations. Please see full details and rates included in the table below:

Route	Valid 11 January 2018	Operated by
Madikwe to Marataba	1-3 guests - ZAR 4,408.00 per vehicle	MORE Private Travel
	4-7 guests - ZAR 5,730.00 per vehicle	

### Air Transfers between Madikwe Safari Lodge and Marataba Safari Lodge

Unique Air has launched its Safari Link circuit, linking the Sabi Sand Game Reserve with Welgevonden, Madikwe and Marataba.

### Sabi Sand & Madikwe (inclusive of VAT)

Departure Lodge	Departure Time	Arrival Lodge	Arrival Time	2017 Rate (valid until 29/02/17)
Sabi Sand (any lodge)	11h00 - 11h30	Madikwe	12h30 - 13h00	R9 050 pp per way
Madikwe	13h15 - 13h30	Sabi Sand (any lodge)	14h45 - 15h00	R9 050 pp per way

#### PLEASE NOTE:

1. All mentioned road transfer and flight rates are subject to change without prior notice. As these services are outsourced and are not offered directly by Madikwe Safari Lodge, the rates are determined by the service provider and we are unable to guarantee them.
2. Please note all rates quoted are NETT and non-commissionable.

## Directions

Please **DO NOT** follow your GPS to Marataba. Many of the prescribed roads are not navigable in a normal vehicle. Following GPS co-ordinates may result in getting lost in the middle of the bush, or unnecessary delays.

### Recommended Route to Madikwe Safari Lodge (4.5 hours)

**NOTE: This route is recommended if you do not mind travelling 50 kilometers/30 miles on a gravel road, or if you are coming from or going to Sun City. This is a shorter route in distance, does not require a 4x4 vehicle and is more scenic.**

- Starting at Oliver Tambo International Airport (ORT)
- Depart ORT following the airport exit signs (R21 & R24)
- Approximately 200m thereafter the road forks. Take the right fork towards R21 N Pretoria/R24 Johannesburg
- The road immediately turns sharply right. Stay in the left lane immediately and follow the signs to R21 N Pretoria while exiting the airport
- After exiting the airport, get into the left lane and follow the R21 N Kempton Park/Pretoria signs
- After 300m, take the left off ramp following the R 21 N Kempton Park/Pretoria signs
- Once on the R21 N drive for 36.3 km
- After 34km you will see signs indicating exit 134 (N1 Noord, Pretoria/Polokwane/Johannesburg)
- Take exit 134
- Immediately thereafter the road forks. Take the right fork towards N1 North Polokwane
- Travel for 22.5km along the N1
- After 20km look for exit 156 to the left (N4 Rustenburg). Take exit 156 and get onto N4 to Rustenburg.
- The N4 is a toll road so please be aware of toll taxes (2 x toll gates), which will be an approximate total of ZAR 30.00 per sedan vehicle. Please note these rates are exclusive of eToll fees. Payment can be made with cash or credit card.
- Once on the N4 continue for 62 km
- Take exit 225 for the R556 Sun City/Majakaneeng
- Turn right at the top of the off-ramp towards Sun City and continue straight to Sun City (approximately 73 km /45 miles from this off-ramp). It is advisable to fill up with fuel at the Sun Village, just after the Sun City entrance on the right
- After passing Sun City and the Sun Village on the right, continue straight until you reach a four-way junction
- Turn right to DERDEPOORT, follow the road for approximately 8 km/5 miles
- Turn left at the sign for BAPONG. Continue straight along this road. Please ignore all signs for Madikwe Hospital or Village etc
- After passing through MABESKRAAL (approximately 45 km/28 miles), you will come to a four-way stop where you must turn right to DERDEPOORT. This newly-tarred/ sealed road continues for about 25 km/16 miles and has very few signs. It then becomes gravel/dirt, with the Dwarsberg Liquor Store on your left, after which you continue for 58 km/36 miles
- Continue straight along the gravel road towards MOLATEDI village (do not take the next Derdepoort road to the right, continue straight)
- Pass through the Molatedi village, over the Marico River and straight to the MOLATEDI GATE entrance into the reserve which will be approximately R85 per car per gate
- Here you will be welcomed by the friendly gate staff, who will confirm your reservation and direct you to the correct Lodge at Madikwe Safari Lodge
- Proceed into the reserve on the main road following the signs to the DERDEPOORT gate/MADIKWE SAFARI LODGE, approximately 33 km/20 miles and it should take you approximately 45 minutes
- Please note the reserve speed limit is 40 km/h or 25 miles/h
- Welcome to MADIKWE SAFARI LODGE, where a great few days on safari awaits. It's time to relax, we will take care of everything from here on out!
- Please contact the Lodge on +27 18 350 9902 to advise us when you have passed Sun City

### Abajaterskop Gate

- Starting at Oliver Tambo International Airport (ORT)
- Depart ORT following the airport exit signs (R21 & R24)
- Approximately 200m thereafter the road forks. Take the right fork towards R21 N Pretoria/R24 Johannesburg
- The road immediately turns sharply right. Stay in the left lane and follow the signs towards R21 N Pretoria while exiting the airport
- After exiting the airport, get into the left lane immediately and follow the R21 N Kempton Park/Pretoria signs
- After 300m, take the left off ramp following the R21 N Kempton Park/Pretoria signs
- Once on the R21 drive for 36.3 km
- After 34km you will see signs indicating exit 134 (N1 Noord, Pretoria/Polokwane/Johannesburg)
- Take exit 134
- Immediately thereafter the road forks. Take the right fork towards N1 North Polokwane
- Travel for 22.5km along the N1
- After 20km look for exit 156 to the left (N4 Rustenburg). Take exit 156 and get onto N4 to Rustenburg

- The N4 is a toll road so please be aware of toll taxes (3 x toll gates), which will be an approximate total of ZAR 65.00 per sedan vehicle. Please note these rates are exclusive of eToll fees. Payment can be made with cash or credit card.
- Once on the N4 drive 236km. The N4 will go past Brits, Rustenburg, Marico and then you will arrive in Zeerust
- In Zeerust, be sure to refuel as there is no fuel available in the reserve
- Turn right at President Street onto the R47/R49 to Gaborone
- It is 90km/56 miles to the Abjaterskop Gate, where you will enter Madikwe Game Reserve. The gate is on your righthand side
- Here you will be welcomed by the friendly gate staff, who will confirm your reservation and direct you to the correct camp at Madikwe Safari Lodge
- Now, you will travel on a gravel road (travelling time is approximately 45 minutes) towards Derdepoort for approximately 11 km/7 miles. Turn left at the T-junction
- On your way, you will pass a signboard to Derdepoort Gate after 2 km/1.2 miles, and again 1.1 km/0.68 miles later - just follow the directions to the Derdepoort Gate
- After approximately 5 km/3.1 miles, you will drive through the "Ambush Alley" mountain pass. Here you will see a sign warning drivers to be mindful of klipspringers in the area
- Continue on the same road and after 5 km/3.1 miles, there is a crossroad where you will still continue straight
- Continue until you see the sign for Madikwe Safari Lodge (with the relevant Lodge name), where you turn right, off the main road and continue to the Lodge.
- Welcome to MADIKWE SAFARI LODGE, where a great few days on safari awaits. It's time to relax, we will take care of everything from here on out!
- Please contact the Lodge on +27 18 350 9902 to advise us when you have passed the town of Zeerust

### **From Madikwe Safari Lodge to Marataba Safari Lodge (2 hours)**

- Follow lodge exit signs from the lodge to the main Reserve road
- At T-junction with main gravel road turn right towards Derdepoort Gate
- Continue straight for 8.4km to Derdepoort Gate (Please note there will be 40km of gravel road ahead.)
- After passing through Derdepoort Gate, turn right at the 4-Way Stop towards Swartruggens
- Continue straight for 20.6km and turn left towards Dwaalboom
- Continue for 5.5km and take turn off for Maricodaal
- Continue straight for 3.6km and take right fork towards Dwaalboom
- Continue for 88km along the road. Gravel turns into a tar road (There are potholes for the first 50 km of tarmac.)
- At T-junction turn right towards Thabazimbi
- Continue straight for 14.2km and turn left at Lephallale on the R510
- Continue straight for 11.2km and take right turn off for Rooiberg
- Continue along the gravel road for 8 km, Marataba Gate will be on your left hand side
- Follow lodge signs towards the lodge

### **Madikwe Game Reserve Airstrips Coordinates**

**Eastern Airstrip:** S 24°44' 00.0" | E 026° 24' 25.0"

**Western Airstrip:** S 24° 49' 23.0" | E 026° 13' 25.0"

The Eastern Airstrip is tarred and about 10 minutes from Madikwe Safari Lodge, while the Western Airstrip is gravel and roughly 45 minutes from the Lodge.

### **Madikwe Game Reserve Gate Entrance Fees**

**Gate entrance fees into the Madikwe Reserve are as follows for 2017:**

ZAR 210.00 per adult and ZAR 105.00 per child per stay (subject to changes dictated by the reserve)

#### **PLEASE NOTE:**

- Madikwe Reserve entrance fees are payable per person directly at the Lodge and will be added to guest's extras bill
- It is safe to drive, so don't worry about driving through the rural areas. The locals' sense of community and the importance of your security are very highly regarded
- Please advise us of your estimated time of arrival and note that winter (May to September) afternoon game drives depart at 15h30, and summer afternoon game drives at 16h30
- Please drive carefully, and be aware of village pedestrians, their children and domestic animals
- There are always a number of speed traps with traffic police along the way, so please be sure to observe the speed restrictions
- The elephants at Madikwe Game Reserve must be treated with respect, so please keep a safe distance and don't get out of the vehicle for any reason
- Please take note that the Madikwe Game Reserve gate opens at 06h00 and closes at 21h00
- Please advise the Lodge if you will be arriving outside of these times so that the necessary arrangements can be made on your behalf