

STANLEY & LIVINGSTONE

BOUTIQUE HOTEL

HOTEL - FACT SHEET 2019

About Stanley & Livingstone Pg1 | Weather Pg2 | Architectural Layouts Pg3 | Reference Table Pg5

Stanley & Livingstone Boutique Hotel | VoIP: +263 8677 000 457/Alternate tel: +263 83 284 1003/5/6 | Email: alan@stanleyandlivingstone.co.zw
MORE Head Office/Reservations | Tel: +27 (0)11 880 9992 | Email: res@more.co.za | Website: www.stanleyandlivingstone.co.zw
www.more.co.za

Stanley & Livingstone Boutique Hotel

The area's first boutique hotel comprises just 16 luxury Suites and welcomes guests (of all ages) to pause on a spectacular Southern African itinerary. Its elegant-yet-approachable design is a fresh take on colonial style, and its spaces – a restaurant, bar, lounge, terrace, and serviced pool facing onto landscaped gardens – encourage guests to settle in and feel at home. Every comfort, attentive service and good food enhance the experience, ensuring guests are very well taken care of.

Unique Selling Points

- Victoria Falls' first boutique hotel
- Primely located a 15-minute drive from the area's namesake Victoria Falls – a UNESCO World Heritage Site and acclaimed Natural Wonder of the World
- Just 16 luxury Suites, both elegant and approachable in their décor, encourage guests to settle in and feel at home
- Guests of all ages are welcome, and well-catered for with family-friendly accommodation, meal, and activity offerings
- The hotel's gourmet restaurant makes dining an occasion – as anticipated as the activities
- The hotel's own Private Travel Desk is available to take care of all guest arrangements, from activities – on and off the property – and restaurant reservations, to travel transfers
- Complimentary, shared airport transfers between the hotel and Victoria Falls International Airport, and Harry Mwanga Nkumbula International Airport (formerly Livingstone Airport)
- Complimentary, daily-scheduled transfers between the hotel and Victoria Falls town
- The hotel is both an ideal base from which to explore and a tranquil place to pause in one of the continent's most visited destinations

A Closer Look at Stanley & Livingstone Boutique Hotel

- 16 luxury Suites, each with: a private terrace, en-suite shower and bath, air conditioning, minibar, satellite television, and telephone
- All Suites can be configured as double or twin
- Two sets of Suites are interleading (7 & 8 and 9 & 10), and each set includes a triple Suite
- A gourmet restaurant serving breakfast, lunch, and dinner in the dining room, on the terrace, or out in the gardens
- A lounge and bar, with a menu of MORE coffees and a selection of beers, wines, champagnes, spirits, and speciality cocktails
- A view/dining terrace looking onto the gardens, with tables set out for meals, coffees, and sundowners
- A garden swimming pool, with shaded loungers and serviced by the restaurant
- A Private Travel Desk to organise activities, on and off the property, and other guest trip arrangements
- Complimentary Wi-Fi throughout the hotel
- Complimentary, shared transfers between the hotel and Victoria Falls International Airport, and Harry Mwanga Nkumbula International Airport (formerly Livingstone Airport)
- Complimentary, daily-scheduled transfers between the hotel and Victoria Falls town

Weather

- Hot summers from September to April, and mild winters from May to August
- During summer, daytime high temperatures average 30°C/86°F, while night-time lows seldom drop below 14°C/57°F
- The summer rains wash through the area between November and March, and dramatic thunderstorms may light up the afternoons
- During winter, daytime high temperatures average 20°C/68°F, while night-time lows average a chilly 8°C/46°F
- Winter is the dry season, and days are usually clear and sunny

Best Time to Travel

- A year-round travel destination, with hot summers and mild winters
- February to May: last months of the rainy season, when the Victoria Falls have their highest flow and are at their most impressive
- June to August: warm days and cool evenings, with little to no rain, but plenty of water still flows over the falls
- October to November: dry months, when the falls are at their lowest – but without the dense spray from the falls, visitors are afforded a clear view
- Water flow over Zimbabwe's side of the falls is permanent, with the volume changing according to the seasons

Health Info

Malaria: Stanley & Livingstone Boutique Hotel is located in a malaria area, and we urge guests to consult their doctors about malarial prophylactics before visiting.

Yellow fever: There is no risk of yellow fever in Zimbabwe. Proof of vaccination on applying for a Zimbabwean visa is only required if guests are travelling from a yellow fever-affected country (e.g. Zambia).

Stanley & Livingstone Boutique Hotel Layout

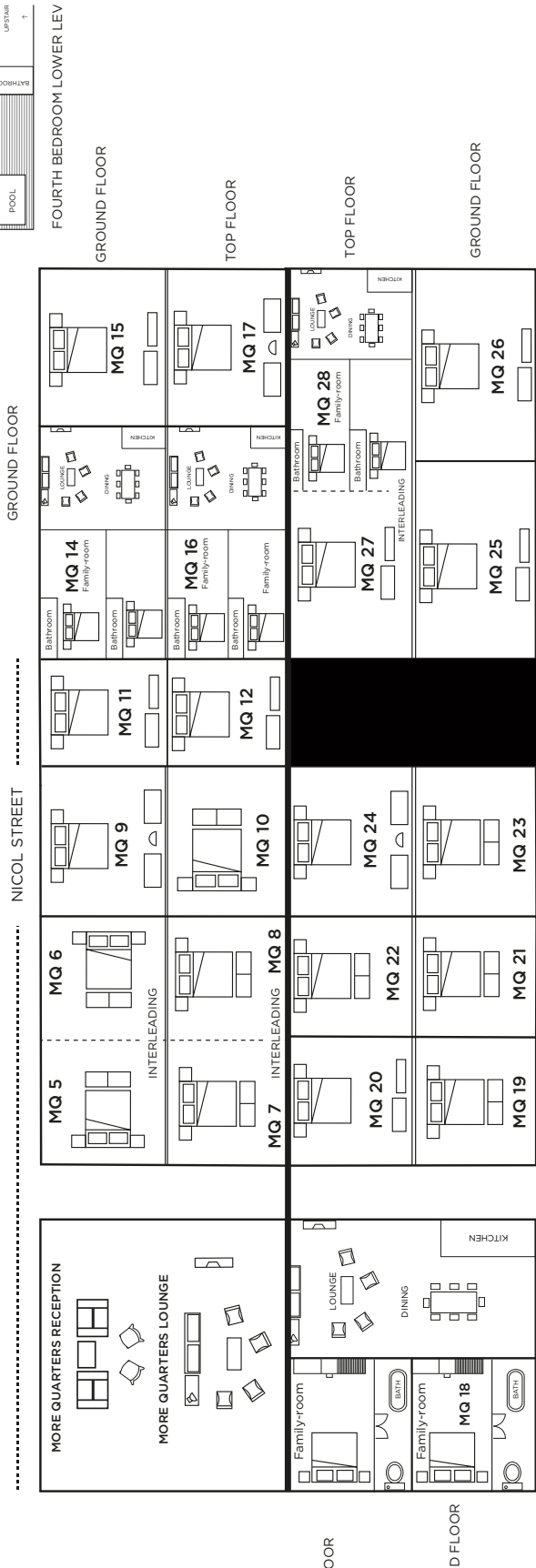
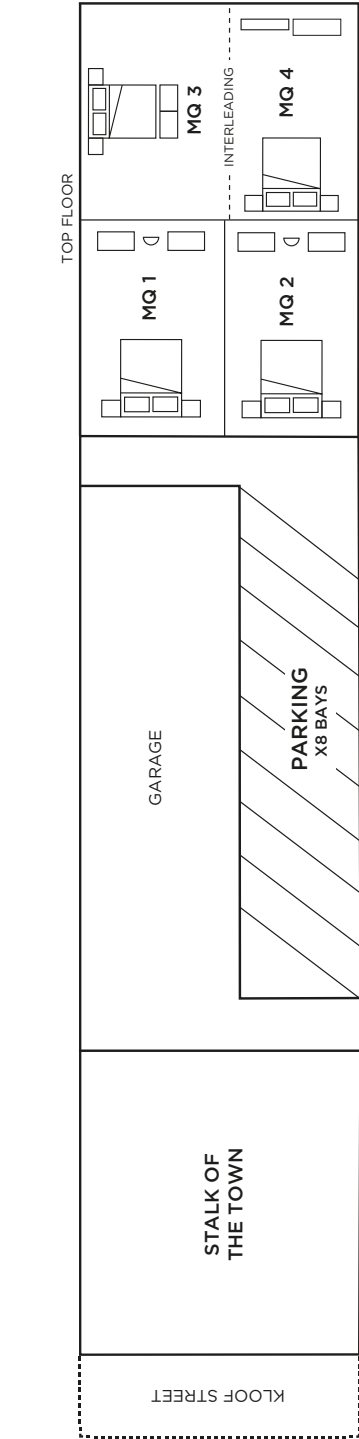
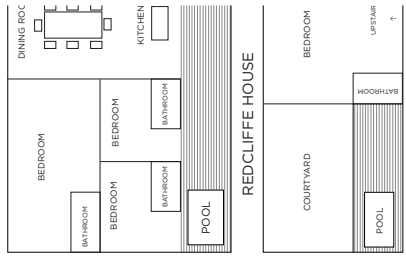

Suite Layout

Suite Size:
70m²/753ft²

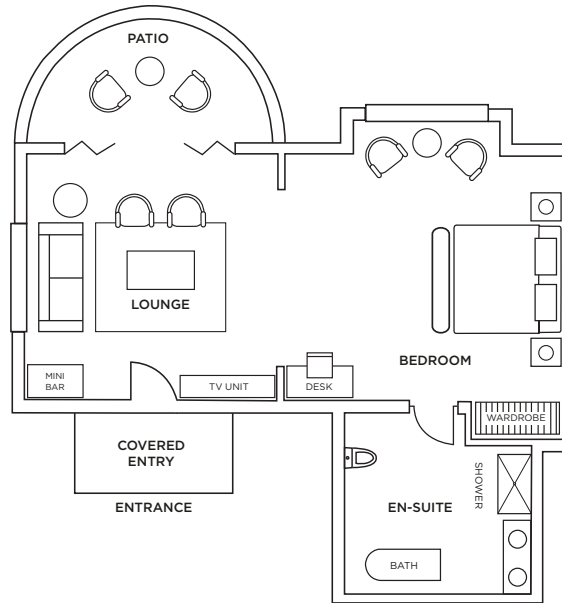

Interleading Suite Layout

Suite Size:
70m²/753ft²

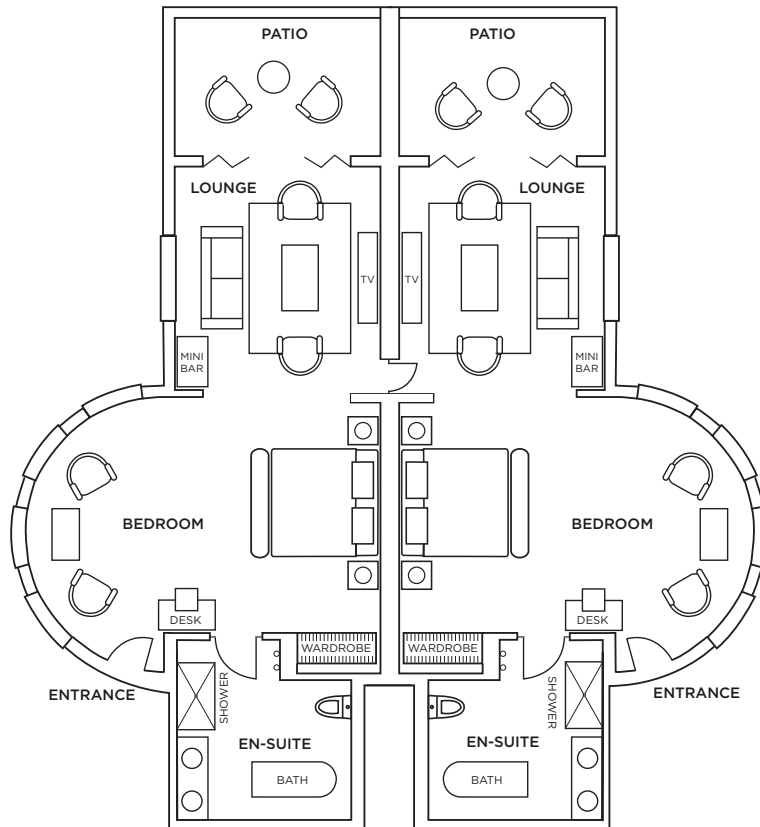

Reference Table – Stanley & Livingstone Boutique Hotel

Reference			
Suites	16 (separate suites)	Free Wi-Fi	Yes (all areas)
Suite size	70m ² /753ft ²	Satellite television	Yes
Private terrace	Yes	In-room safe	Yes
Guests	34	Minibar	Yes
Children	Yes (all ages)	Telephone	Yes
Baby cots	Yes	Laundry	Yes (additional cost)
Childminding	Yes (additional cost)	Spa facilities	In-room treatments (additional cost)
Triple suites	Yes (x2 suites)	Suitable for disabled guests	Yes (x1 suite)
Interleading suites	Yes (x2 sets)	Parking	Yes (valet)
Single-traveller supplement	Yes (50% supplement)	Meals	Restaurant serving: breakfast, lunch, dinner
Double bed, convertible to twin	Yes	Room service	Yes (07h00 to 21h30)
Central guest pool	Yes	Gratuitie recommendation	At guests' discretion
Private plunge pools	No	Kosher dining	Yes (with prior notice, at an additional cost)
Air conditioning	Yes	Closest airport	Victoria Falls Intl Airport (20 minutes away)
Mosquito nets	Yes	Comp. shared airport transfers	Victoria Falls Intl Airport; Harry Mwanga Nkumbula Intl Airport (Livingstone Airport)
Fireplace	Yes (guest lounge)	Comp. shared Victoria Falls town transfers	Daily – Departing: 08h00; 11h00; 15h00 Returning: 11h30; 15h30
Shower	Yes (separate)	Activities, tours, and excursions	Yes (additional cost)
Bath	Yes (separate)	Power	220V AC (UK adaptors)
Separate WC	Yes	Credit cards	Visa, MC, Amex